

Copper Tube Compression Lugs

A-M Series

2-1/0 to 3/0-250 MCM

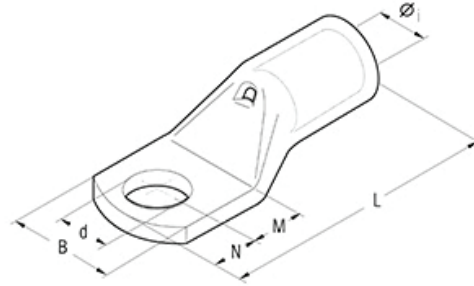

Cond. Size AWG	Ø Stud. Inches	ASI Part Number	ASI Type	Dimensions Inches						Pkg. Per Bag	Hydraulic Tools
				Øi	B	M	N	L	d		
2-1/0	1/4"	2220070	A10-M6	0.39	0.83	0.31	0.28	1.73	0.25	50	B 35-50MA
	5/16"	2220110	A10-M8	0.39	0.83	0.35	0.31	1.81	0.33	50	
	3/8"	2220150	A10-M10	0.39	0.83	0.43	0.39	1.97	0.41	50	
	1/2"	2220190	A10-M12	0.39	0.87	0.55	0.47	2.17	0.52	50	
	9/16"	2220230	A10-M14	0.39	0.98	0.63	0.55	2.32	0.59	50	
1/0 Fine Strand	5/16"	2230230	A12-M8	0.43	0.76	0.43	0.31	1.67	0.33	50	
	3/8"	2210270	A12-M10	0.43	0.76	0.43	0.39	1.83	0.41	50	
	1/2"	2230310	A12-M12	0.43	0.87	0.55	0.47	2.03	0.52	50	
1/0-2/0	1/4"	2240110	A14-M6	0.44	0.83	0.31	0.28	1.73	0.25	50	
	5/16"	2240150	A14-M8	0.44	0.83	0.35	0.31	1.81	0.33	50	
	3/8"	2240230	A14-M10	0.44	0.83	0.45	0.37	1.97	0.41	50	
	1/2"	2280190	A14-M12	0.44	0.87	0.47	0.47	2.17	0.52	50	
	9/16"	2240310	A14-M14	0.44	0.98	0.63	0.55	2.32	0.59	50	
	5/8"	2240350	A14-M16	0.44	1.02	0.71	0.63	2.48	0.67	50	
2/0 Fine Strand	1/4"	2250210	A17-M6	0.51	0.91	0.31	0.28	1.77	0.25	50	
	5/16"	2250230	A17-M8	0.51	0.91	0.35	0.31	1.85	0.33	50	
	3/8"	2250270	A17-M10	0.51	0.91	0.43	0.39	2.01	0.41	50	
	1/2"	2250310	A17-M12	0.51	0.91	0.55	0.47	2.20	0.52	50	
	9/16"	2250350	A17-M14	0.51	0.98	0.61	0.47	2.26	0.59	25	
2/0-3/0	1/4"	2260110	A19-M6	0.53	0.98	0.31	0.28	1.99	0.25	25	
	5/16"	2260150	A19-M8	0.53	0.98	0.35	0.31	2.07	0.33	25	
	3/8"	2260190	A19-M10	0.53	0.98	0.43	0.39	2.22	0.41	25	
	1/2"	2270310	A19-M12	0.53	0.98	0.55	0.47	2.42	0.52	25	
	9/16"	2260270	A19-M14	0.53	0.98	0.63	0.55	2.58	0.59	25	
	5/8"	2260310	A19-M16	0.53	1.06	0.71	0.63	2.74	0.67	25	
3/0 Fine Strand	3/8"	2270270	A20-M10	0.59	1.06	0.43	0.39	2.13	0.41	25	
	1/2"	2270310	A20-M12	0.59	1.06	0.55	0.47	2.32	0.52	25	
	9/16"	2270350	A20-M14	0.59	1.06	0.61	0.47	2.38	0.59	25	
	5/8"	2270390	A20-M16	0.59	1.06	0.65	0.53	2.48	0.67	25	
	3/4"	2270430	A20-M20	0.59	1.16	0.87	0.79	3.05	0.83	25	
3/0 AWG-250 MCM	5/16"	2280110	A24-M8	0.60	1.12	0.35	0.31	2.13	0.33	25	
	3/8"	2280150	A24-M10	0.60	1.12	0.43	0.39	2.28	0.41	25	
	1/2"	2280190	A24-M12	0.60	1.12	0.55	0.47	2.48	0.52	25	
	9/16"	2280230	A24-M14	0.60	1.12	0.63	0.55	2.64	0.59	25	
	5/8"	2280270	A24-M16	0.60	1.12	0.71	0.63	2.80	0.67	25	
	3/4"	2280310	A24-M20	0.60	1.18	0.87	0.79	3.11	0.83	25	

